

# 10B Carnegie Place, Portmahomack

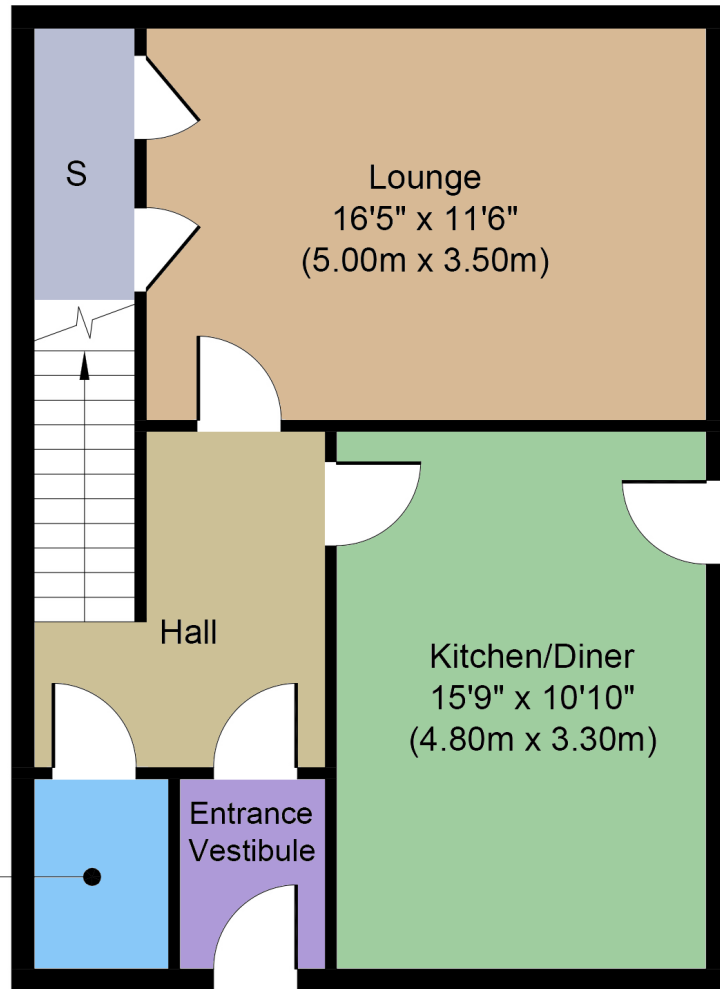

Georgesons  
Estate Agents

Toilet  
5'7" x 3'11"  
(1.70m x 1.20m)



## Ground Floor

Approximate floor area:  
542 ft<sup>2</sup>  
(50.4 m<sup>2</sup>)

Bathroom  
6'7" x 6'3"  
(2.00m x 1.90m)

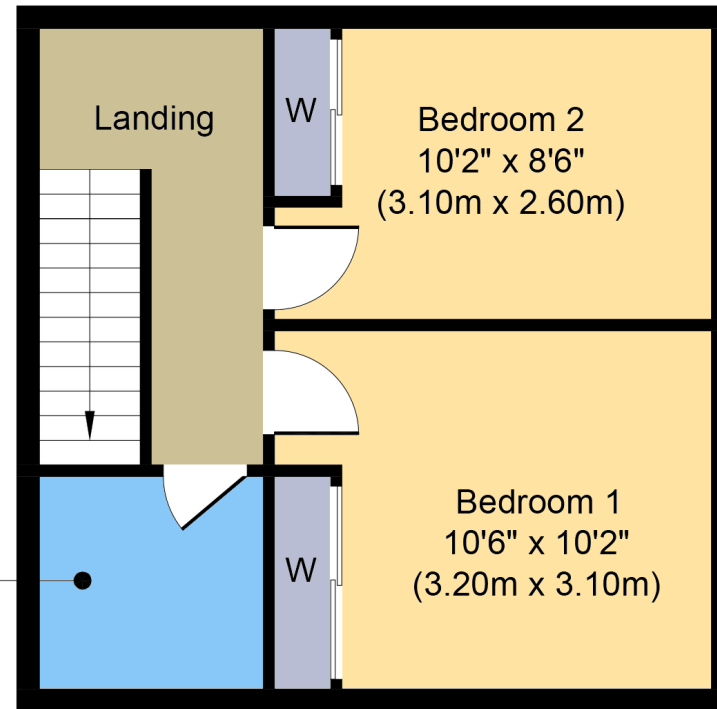

## First Floor

Approximate floor area:  
381 ft<sup>2</sup>  
(35.4 m<sup>2</sup>)

Whilst every attempt has been made to ensure the accuracy of the floor plan contained here, measurements of doors, windows, rooms and any other items are approximate and no responsibility is taken for any error, omission, or miss-statement.

This plan is for illustrative purposes only and should only be used as such by any prospective purchaser or tenant.